



Wilderness Division

Good Will Builders, Inc.

417-626-9663



the REMINGTON

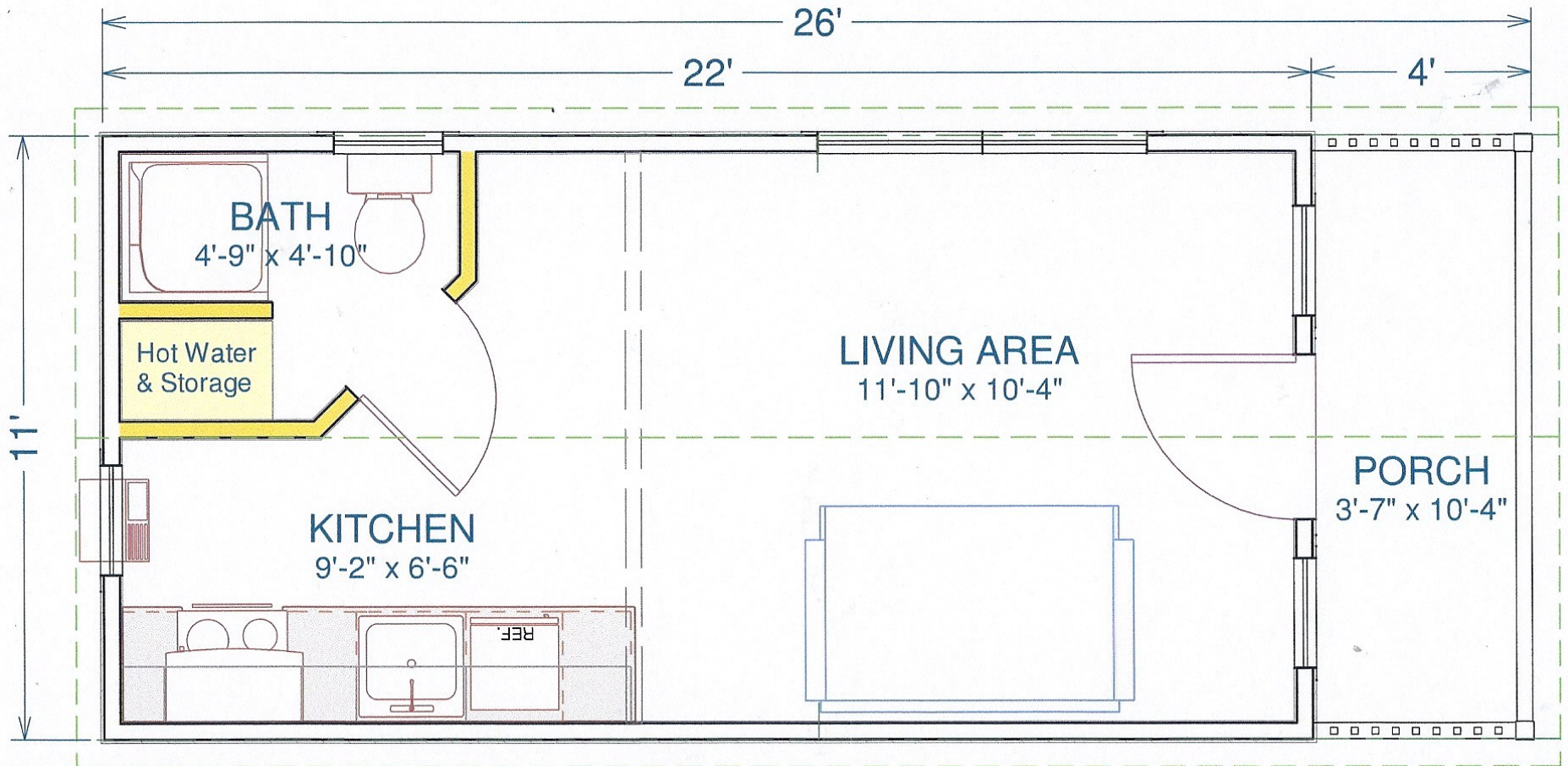

Good Will Builders

Family Owned and Operated, Since 1986.

417-626-9663 ~ www.goodwillbuilders.com

AMERICA'S CABIN BUILDERS



Ask About Our Many Amenities!

- Block, Pier & Concrete Foundations
- Many wood species available, (Inc. most hard & soft woods)
- Solar Panels
- Separated Gray-Water & Sewage
- Rain Water Reserve Catchment Systems
- Sky-lighting
- Structural Insulated Panels
- 12V & 120V systems available
- Raised Heel Energy Trusses
- Custom Cabinets
- Marble & Granite Counter-Tops
- Hand-Crafted Wood Furnishings
- Murphy's Beds & Slab-Top Tables
- Wood-Burning Stoves & Flues
- Hand-Crafted Log Railings
- Composting & Incinerating Toilets
- PORTABLE or BUILT-ON-SITE

Wilderness & Sustainability

division of:



the REMINGTON

- 11'x22' Heated Living Space
- 11'x4' Covered Porch
- Wired for Conventional & Generator
- Thru-Wall 110amp Heat/Air Unit
- Knotty-Pine Interior Walls
- Galvanized Metal Ceiling
- Custom-Built Cabinetry
- Granite Counter-Tops
- Solid Fir Flooring
- Zero Maintenance
- **COMPLETELY CUSTOMIZABLE**

\$26,800

\$1700 Extra for Murphy's Bed

Delivered within 100 miles of Joplin, Mo